

Proposed Project at Premises No-1/1, Kalibari Lane, Ward No-96, Borough-X, under Kolkata Municipal Corporation, P.S.-Jadavpur, Kolkata-700032

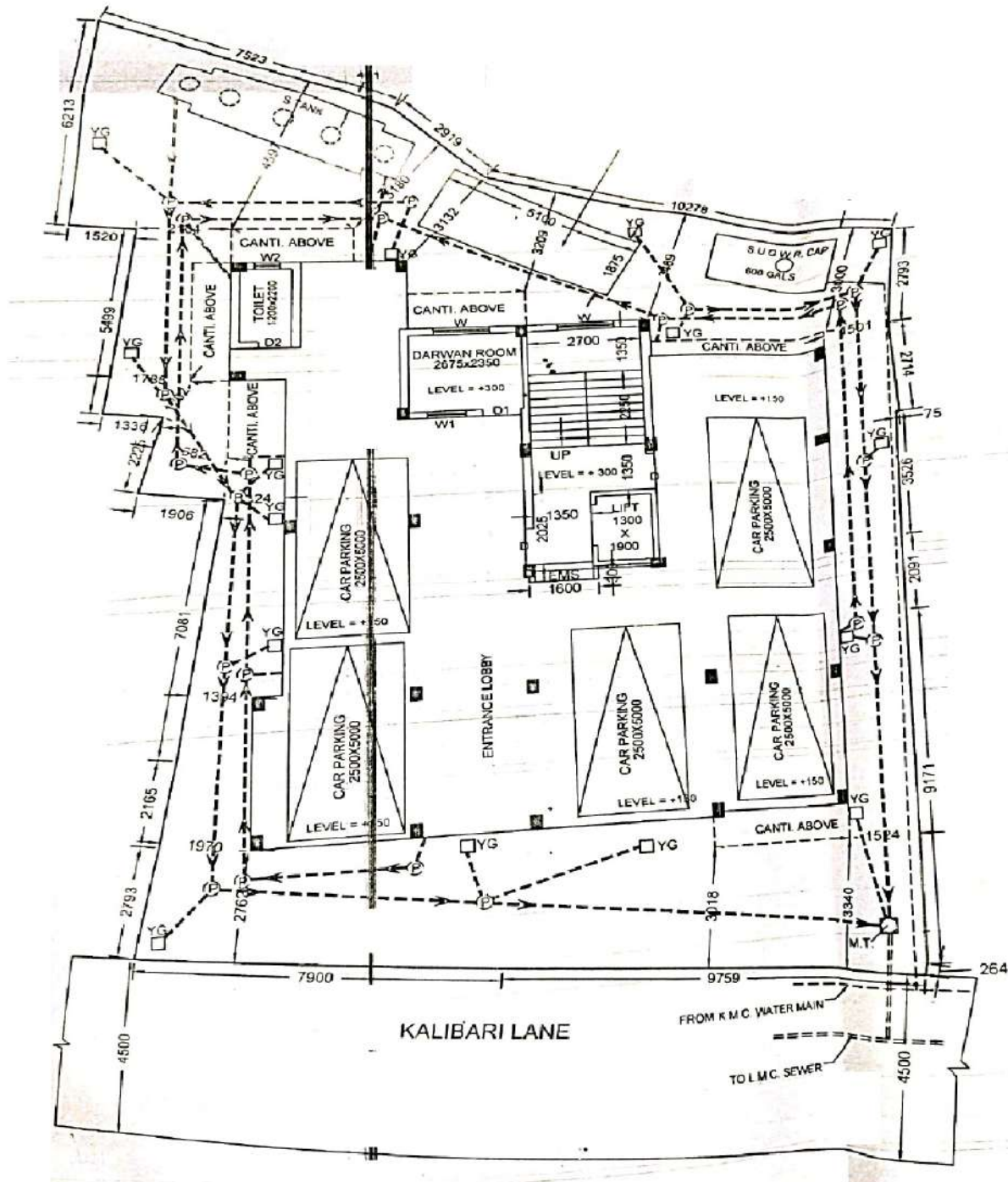

LATITUDE : 22.496563
LONGITUDE : 88.349625

PARASH
Parash Choudhary
Partner

SIGNATURE OF OWNER